

ELECTRICAL

Wire Size:

- Solder Cup Type. One #20 AWG
- Eyelet Type. Two #20 AWG or
Three #22 AWG

Current Rating. 3 Amperes

Withstanding Voltage:

- Contact to Contact Sea Level. . . 1000 VRMS Minimum
- Contact to Ground Sea Level. . . 3300 VRMS Minimum
- Contact to Contact 70,000 Ft. . . . 300 VRMS Minimum
- Contact to Ground 70,000 Ft. . . . 675 VRMS Minimum

MECHANICAL

- Creepage Between Contacts. 0.09 Minimum
- Air Space Between Contacts. 0.03 Minimum
- Contacts to Accept 0.020 ± 0.001 DIA. Pins

Contacts:

- Spring Temper Grade "A" Phosphor Bronze, or
- Heat Treated Beryllium Copper
- Gold Plated over Copper or Nickel Plate

Mounting Hardware:

- Special Studs, Screws, Lockwashers, and Nuts

Insulation Material:

- Choice of "MIL Approved" Thermosetting
- Insulations (See Page 45)

Temperature Ratings: -65°C to +125°C

Weight of Socket with Mountings: 0.23 oz.

CONTACT DATA	CHASSIS MOUNTING DATA			
	CHASSIS THICKNESS	X-DIMENSION	BELOW CHASSIS	ABOVE CHASSIS
 SOLDER CUP	1/16	.17	HRR - 1	HRR - 2
	3/32	.14		HRR - 31 HRR - 32
	1/8	.12		HRR - 41 HRR - 42
 EYELET	1/16	.17	HRR - 5	HRR - 6
	3/32	.14		HRR - 35 HRR - 36
	1/8	.12		HRR - 45 HRR - 46
 STRAIGHT	1/16			HRR - 4
	3/32			
	1/8			

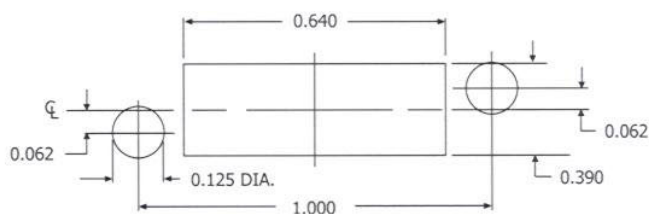

RECOMMENDED CHASSIS CUT-OUT