

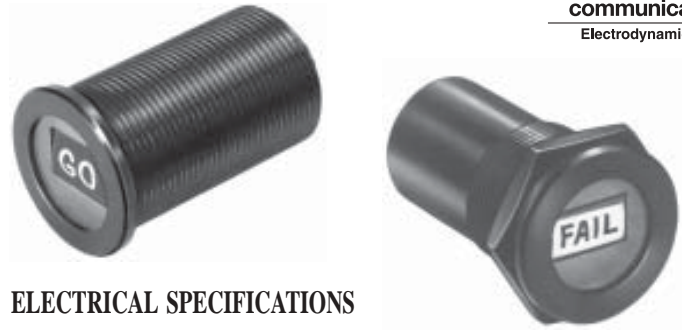

# BITE Indicators

## Latching or Self-Restoring

### Model MI 61 Series



### FEATURES

- Environmentally Sealed
- Choice of Self-restoring or Magnetic Latching Types
- Optional Legend Display

The MI 61 series magnetic latching fault indicator displays a highly visible dual color drum when the indicator coil is pulsed by a BITE (Built-In Test Equipment) system. The drum provides a high contrast visual indication and an effective warning of system faults. The drum can accommodate a legend such as "GO" or "FAIL" when specific information needs to be displayed.

### OPERATION

When the indicator coil is energized with a 50 millisecond or longer pulse, the drum rotates to display the message or system status.

**Model MI 61M** is a self-restoring, steady-state indicator that automatically returns to a neutral state when power is removed. It does not latch to the core magnet, but remains suspended in the position until power is removed. Self-restoring, steady-state indicator.

**Models MI 61L & MI 61LD** are latching indicators that remain magnetically latched to the core in the position last pulsed.

For MI 61L reset to the "no-fault" position is accomplished electrically by reversing the polarity of the pulse.

For the MI 61LD, a dual coil device, reset to the "no-fault" position is accomplished electronically by pulsing the reset coil.

### ELECTRICAL SPECIFICATIONS

Standard Coil Voltages and Resistance:  
Resistance  $\pm$  10% shown at 25°C.

|                   |   |    |    |     |     |     |
|-------------------|---|----|----|-----|-----|-----|
| DC Voltage        | 3 | 5  | 6  | 12  | 24  | 28  |
| Resistance (Ohms) | 6 | 20 | 24 | 103 | 385 | 520 |

**Power:** Steady state for model MI 61 - 1.5 watts.

**Pulse Power for Latching Models:** 1.5 watts, minimal.

**Pulse Length for Latching Models:** 50 ms min.

**Dielectric Withstanding Voltage:** 500 volts DC case to terminals.  
100 VDC coil to coil on dual coil units.

**Insulation Resistance:** 100 megohms minimum at 500 VDC.

### MECHANICAL SPECIFICATIONS

**Case:** Black, anodized aluminum with sealed glass window.

**Mounting:** Front panel mount.

**Weight:** 20 grams maximum.

**Display Colors:** Any combination of: Black (Blk), White (W), and Day Glow\* colors: Red (R), Orange (O), Yellow (Y), and Green (G).

**Legend:** Available maximum letter height 1/8".

**Hardware:** Units supplied with hex nut.

### ENVIRONMENTAL SPECIFICATIONS

**Operating Temperature Range:** -65°C to +125°C.

**Vibration\*\*:** 10 G's, 10 to 2kHz, MIL STD 202.

**Shock:** 50 G's - MIL STD 202, Method 213, Condition I.

**Humidity:** 95% relative humidity MIL STD 202,  
Method 103, Test Condition B.

**Salt Spray:** MIL STD 202, Method 101, Test Condition B.

**Thermal Shock:** MIL STD 202, Method 107, Test Condition A.

**Barometric Pressure:** 100,000 ft. MIL STD 202, Method 105, Test Condition D.

**Operational Life:** 10,000 cycles minimum.

\*Day-Glow Color Corp.

\*\*During vibration testing, caution should be taken to shield the indicator from the strong magnetic field.

Covered by U.S. & Foreign Patents.

### ORDERING INFORMATION

When ordering, show model number first, then coil voltage desired, then the color combination desired. If this is a special part, factory assigned modification number will be added at the end of the ordering number.

Example:

Dual coil magnetically latching unit for 24 volts with black for the fault color and red for reset color would be: Model MI 61LD-24-Blk/R

### MI 61LD - 24 - Blk / R - S

| Basic Model Number | Coil Voltage | Fault or Set Color | Reset Color | Factory Modification Number if Special |
|--------------------|--------------|--------------------|-------------|--|
| MI61M              | 3            | (R) Red            | (R) Red     | S.+ ID No.                             |
| MI 61L             | 5            | (W) White          | (W) White   |  |
| MI 61LD            | 6            | (Blk) Black        | (Blk) Black |  |
|                    | 12           | (G) Green          | (G) Green   |  |
|                    | 24           | (Y) Yellow         | (Y) Yellow  |  |
|                    | 28           | (O) Orange         | (O) Orange  |  |



# BITE Indicators

## Latching or Self-Restoring Model MI 61 Series



FLAG INDICATORS

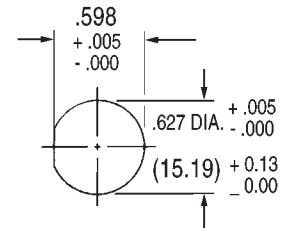
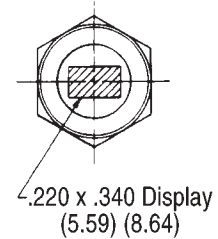
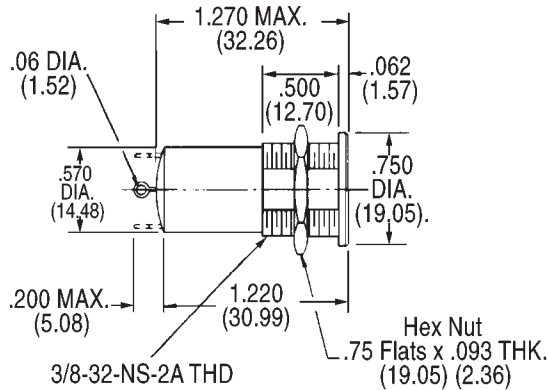
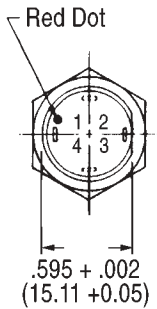

Numbers are for Reference Only.

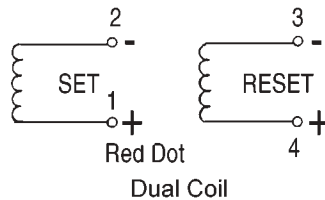
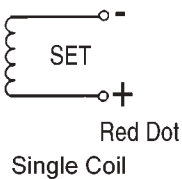

Panel Cut-out

**NOTE:**

Dimensions in ( ) are mm. Tolerances: Decimals:  $\pm .010$  (0,25), Fractions:  $\pm 1/64$ —All mounting hardware is black anodized aluminum. Mounting Torque: 5-7 in. lbs.