



**EL205**

## General characteristics

No. of poles	2 Form C (2PDT)
Volume	3.3 cm <sup>3</sup> [.2 in <sup>3</sup> ]
Mass	16.34 grams [.036 lb. Max]

## Switching characteristics

Operate time @ 25° C (Latch and Reset)	4 ms max.
Bounce time	1 ms max.
Mechanical life	400,000 cycles

Contact rating	Type of load (High level)	Cycles x 10 <sup>3</sup>	28 Vdc	115 Vac		115/200 Vac	
				400 Hz	1 phase	400 Hz	3 phase
	Resistive	100	5 amps	5 amps		5 amps	
	Inductive	20	3 amps	5 amps		5 amps	
	Motor	100	2 amps	3 amps		3 amps	
	Lamp	100	1 amps	n/a		n/a	
	Overload current	n/a	20 amps	30 amps		30 amps	
	Rupture current	n/a	25 amps	40 amps		40 amps	

## Environmental characteristics

Temperature Range	-70°C to +125°C
Vibration (Sinusoidal)	30 g 70-3000 Hz
Shock, any axis	200 g 6 ms
Seal	Hermetic (1 x 10 <sup>-8</sup> atm cm <sup>3</sup> /s)

## Electrical characteristics

Contact voltage drop (@ Rated resistive load)	
- Initial	150 mV Max.
- After guaranteed life	175 mV Max.
Dielectric strength @ sea level	
- Initial @ 60 Hz	Coil to Case 500 Vrms All other points 1000 Vrms
- After life test @ 60 Hz	350 Vrms 750 Vrms
Insulation Resistance	
- Initial	100 Megohms min. @ 500 Vdc
- After life tests	50 Megohms min. @ 500 Vdc
Reference Military Specifications	MIL-PRF-83536

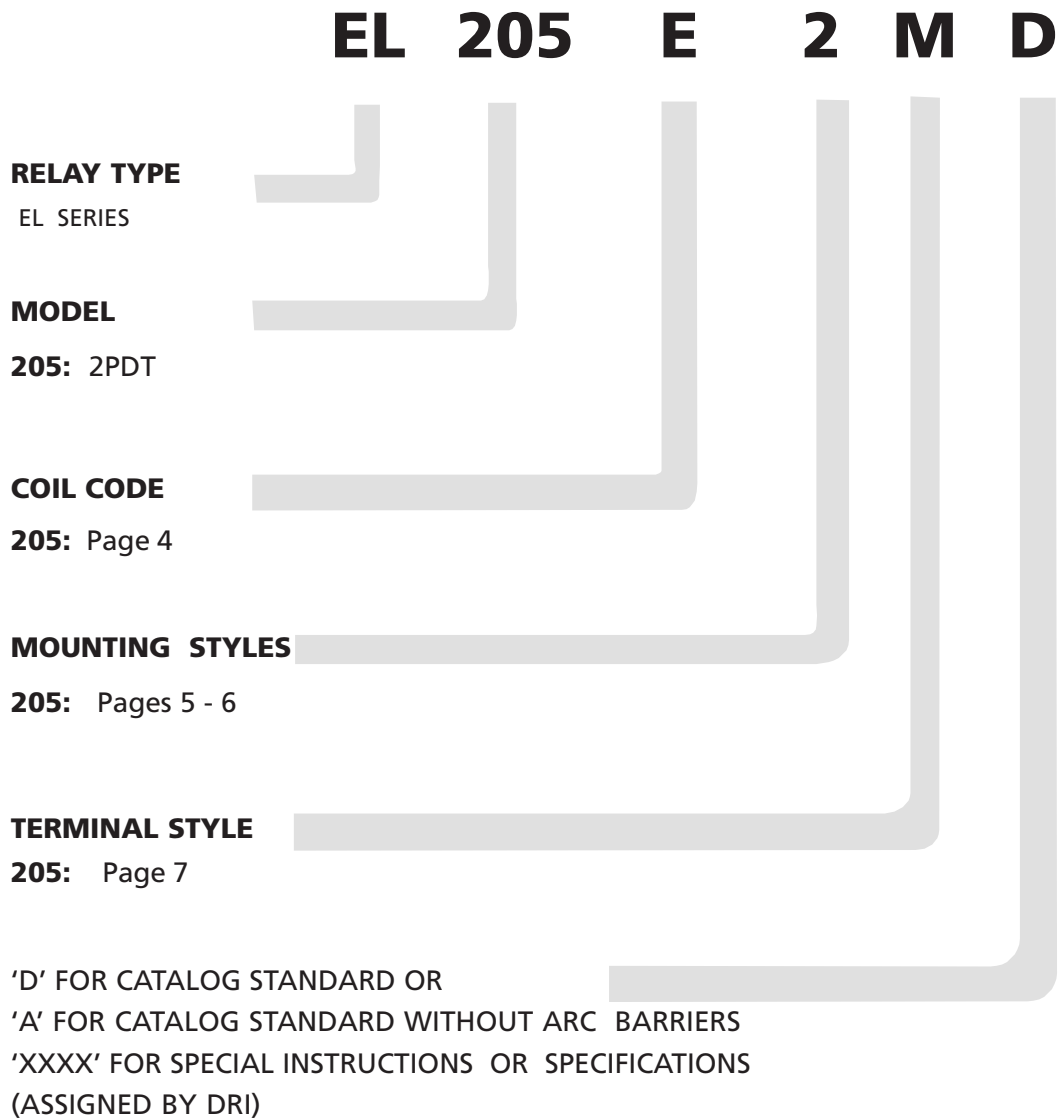

■ [Coil characteristics](#)

COIL CODE	D C
Nominal coil voltage	28
Maximum latch and reset voltage at 25°C	14.5
Maximum latch and reset voltage at 125°C	18
Coil resistance (ohms ± 10% at 25°C)	730

OTHER VOLTAGES AVAILABLE FROM FACTORY ON REQUEST

■ [Circuit diagram](#)

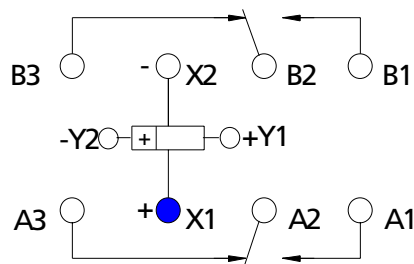

**EL205**  
Y-COIL LAST ENERGIZED

## ■ Mounting styles

DIMENSIONS ARE IN M (IN.)  
UNLESS OTHERWISE SPECIFIED, TOLERANCE IS  $\pm 0,25$  [.010]

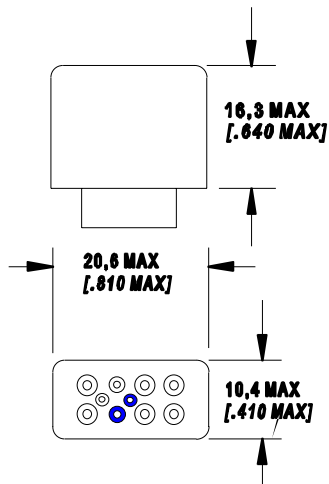

**STYLE 1**  
NO MOUNT

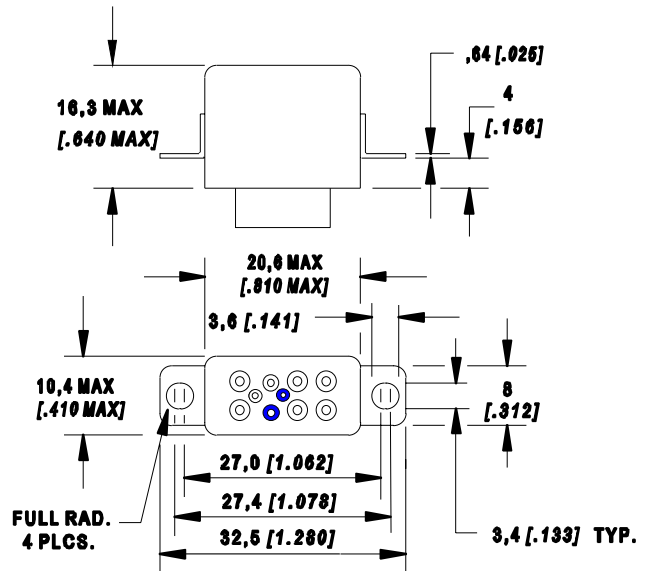

**STYLE 2**  
RAISED VERTICAL FLANGE MOUNT

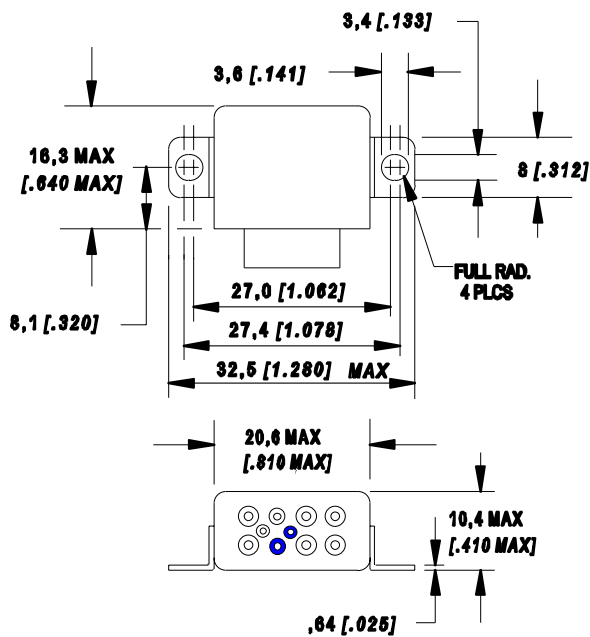

**STYLE 3**  
HORIZONTAL FLANGE MOUNT

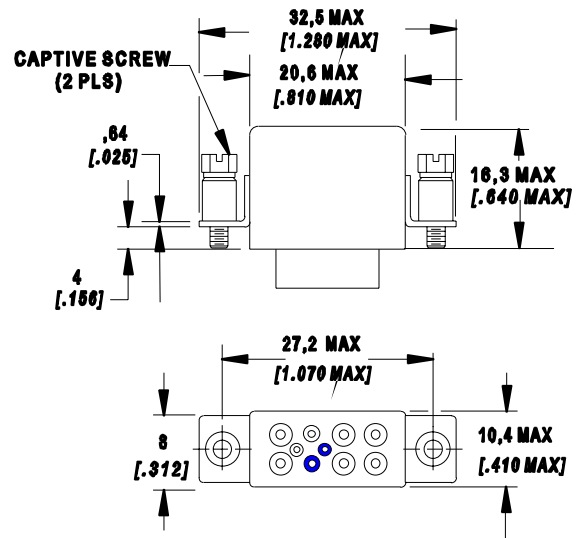

**STYLE 8:** M3 CAPTIVE SCREWS  
**STYLE C:** #4-40 UNC CAPTIVE SCREWS  
RAISED VERTICAL FLANGE MOUNT  
WITH CAPTIVE HARDWARE

## ■ Mounting styles (cont.)

DIMENSIONS ARE IN MM (IN.)  
UNLESS OTHERWISE SPECIFIED, TOLERANCE IS  $\pm 0,25$  [.010]

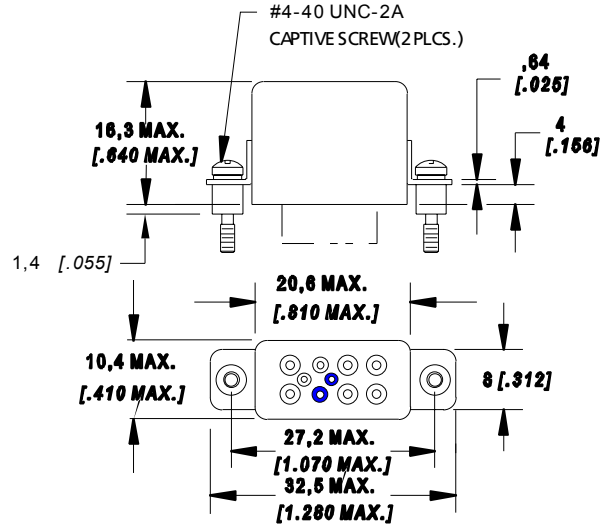

### STYLE G

RAISED VERTICAL FLANGE MOUNT  
WITH CAPTIVE HARDWARE

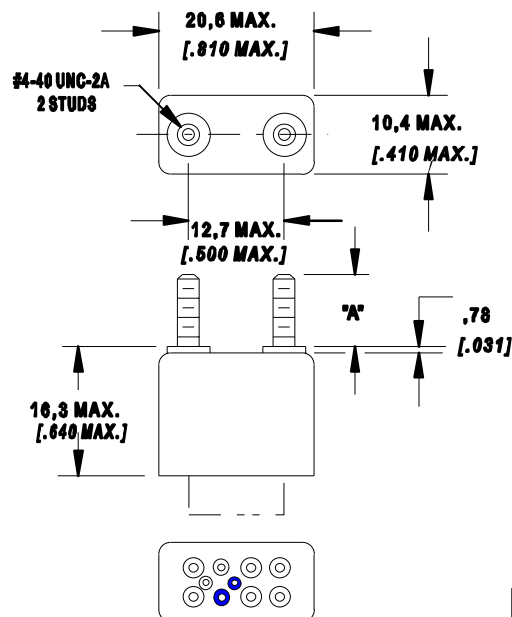

### STYLE M & R TOP STUD MOUNT

STYLE	DIM "A"
M	9,5 [.375]
R	6,35 [.250]

## Termination styles

DIMENSIONS ARE IN MM (IN.)  
UNLESS OTHERWISE SPECIFIED, TOLERANCE IS  $\pm 0,25$  [.010]

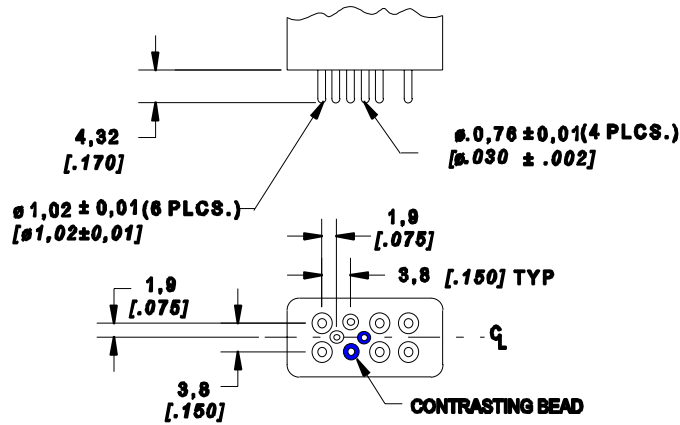

### SOLDER PIN

STYLE A: TIN PLATED

STYLE B: SOLDER DIPPED

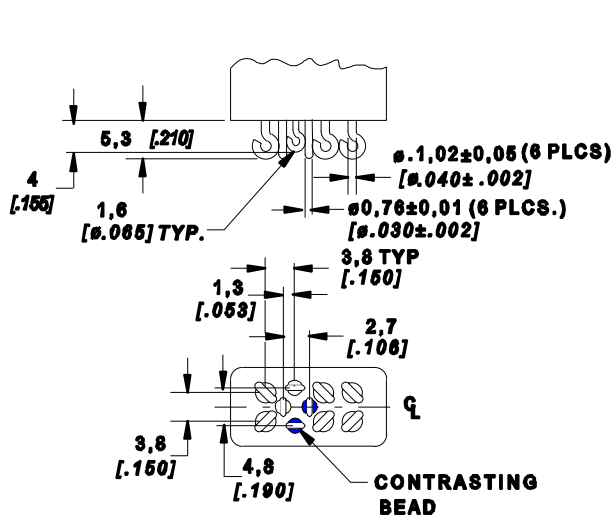

### SOLDER HOOK

STYLE H: TIN PLATED

STYLE J: SOLDER DIPPED

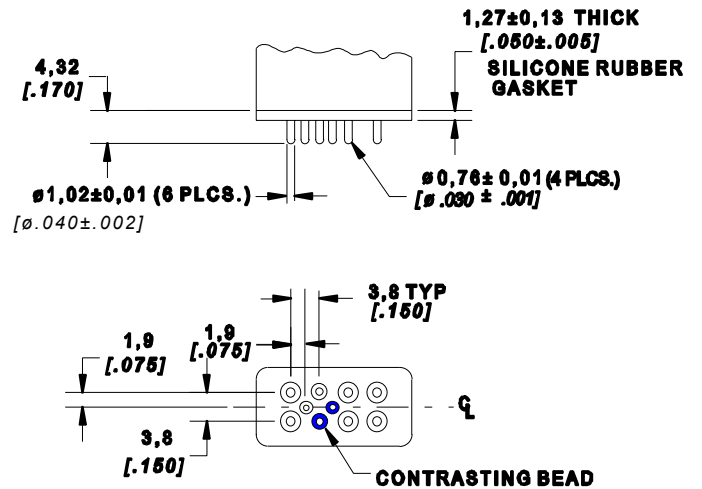

### PLUG IN

STYLE M: GOLD PLATED WITH TIN  
PLATED POLARIZING PIN