



**Basic socket series designation for:**

Series KCL, T531

**NOT qualified but designed to the standards and requirements of::**

MIL-DTL-12883/41

**SOCKET DRAWING**

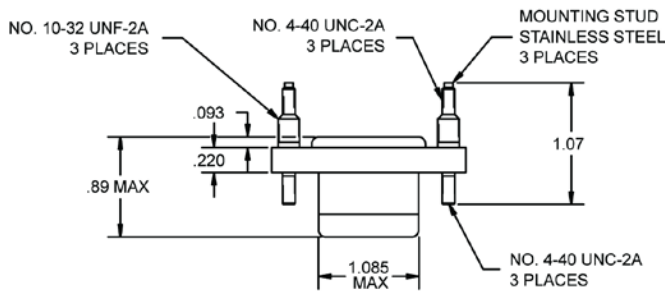
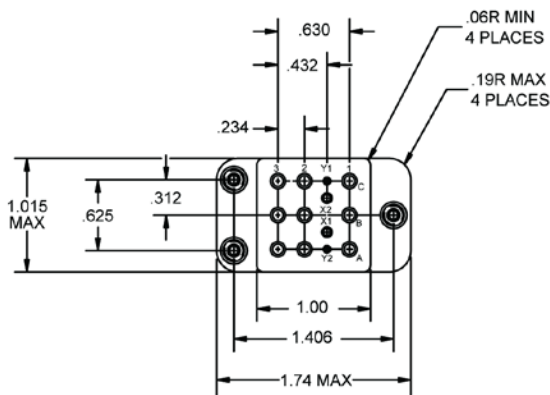

**HARDWARE MOUNTING**

MOUNTING DETAIL 3 PLACES

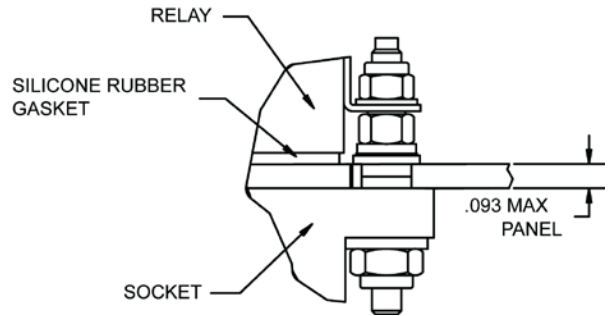

**MOUNTING DIMENSIONS**

SUGGESTED MOUNTING  
HOLE LAYOUT

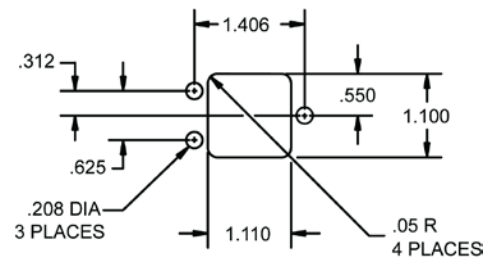

**GENERAL CHARACTERISTICS**

1. Supplied with mounting hardware No. 12, 16 and 20 contacts, No. 12, 16 and 20 crimps.	
2. Standard tolerances	.xx ±.01; xxx ± .005
3. Weight	.120 lbs. max
4. Temperature range	-65° C to +125° C

**AMERICAS.**

Tel: +1 714-736-7599  
<http://www.esterline.com/powersystems>

**EUROPE.**

Tel: +33 3 87 97 31 01  
Fax: +33 3 87 97 96 86

**ASIA**

Tel: +852 2 191 3830  
Fax: +852 2 389 5803