

662 SERIES

SPECIFICATIONS



- $\text{Ø}6.35\text{mm}$ (0.250") mounting
- Black anodized aluminum housing
- Unique hexagonal bezel aids mounting
- Flying lead terminations available
- Sealed to IP67
- Range of LED colors

Complete online datasheet: <http://ds.leds.co.uk/ds/662series.pdf>

DIMENSIONS

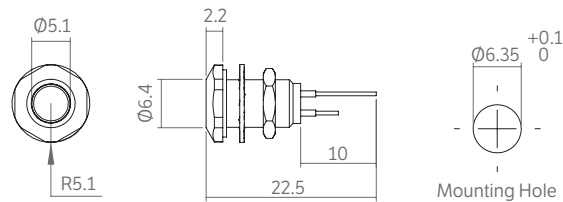

Actual size.
All dimensions measured in mm.

665 SERIES

SPECIFICATIONS



- $\text{Ø}8.5\text{mm}$ (0.335") mounting
- Hard black anodized aluminum housing
- Short body length is ideal for portable equipment
- Unique hexagonal bezel to aid mounting to panel
- Unique PTFE mounting/panel seal
- Sealed to IP68 (10psi) to BS5420
- Ideal for marine and high vibration applications
- Range of LED colors
- Range of voltage options: 20mA

Complete online datasheet: <http://ds.leds.co.uk/ds/665series.pdf>

DIMENSIONS

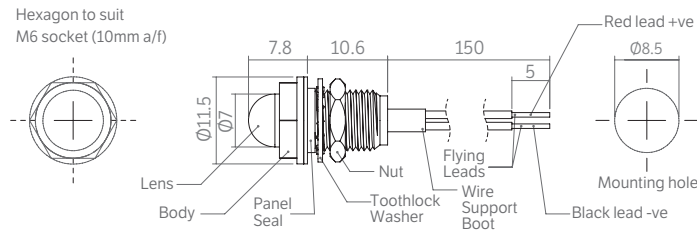

Actual size.
All dimensions measured in mm.