

677 EMC SERIES

SPECIFICATIONS



- Ø8.1mm (0.318") mounting
- EMC version with internal stainless steel mesh
- Black chrome plated aluminum housing with a conductive rubber panel seal
- Sealed to IP67
- Internal reverse protection diode fitted as standard in all voltage models
- Range of LED colors
- Range of voltage options
- EMC version with internal stainless steel mesh on lens assembly
- Flying lead terminations available

Complete online datasheet: <http://ds.leds.co.uk/ds/677emcseries.pdf>

DIMENSIONS

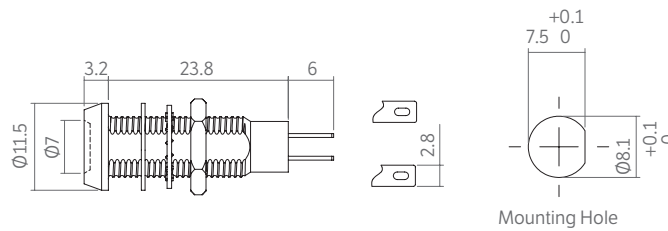

Actual size.
All dimensions measured in mm.

690 SERIES

SPECIFICATIONS



- Ø9.6mm (3.8") mounting
- UL Certified - certificate number E349017
- High intensity LED panel indicator
- Black anodized aluminum housing
- Wide viewing angle
- Internal potting aids vibration
- 8 – 48Vac/dc
- Bi-polar product
- Sealed to IP67 - weather proof
- Range of LED colors
- Range of voltage options

Complete online datasheet: <http://ds.leds.co.uk/ds/690series.pdf>

DIMENSIONS

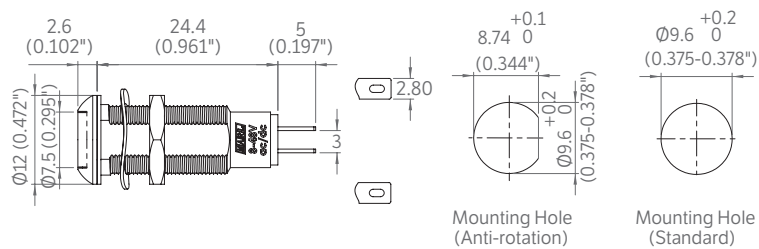

Actual size.
All dimensions measured in mm.