

PRESENTATION

APPAREIL ETANCHE EN FACE AVANT:
BOITIER ET POUSSOIR EN POLYAMIDE 6-6 NOIR
COSSES A SOUDER EN LAITON ARGENTE
CONTACTS: ARGENT

CARACTERISTIQUES MECANIKUES DES 2 DIRECTIONS

FORCES : SUIVANT F

FORCE DE COMMANDE:
FORCE DE RELACHEMENT (FR):
FORCE ADMISSIBLE EN FIN DE COURSE:
TENUE DU POUSSOIR: A LA TRACTION:
A LA COMPRESSION:

ANGLE MESURE PAR RAPPORT A L'AXE DU POUSSOIR
COURSE D'APPROCHE (CA):
COURSE RESIDUELLE ALLER (CRA):
COURSE RESIDUELLE RETOUR (CRR):
ENDURANCE MECANIQUE PAR DIRECTION:
VIBRATION : SELON NORME AIR 7306 TITRE 3
a) SINUSOIDALES : FASCICULE 41 TABLEAU 2
b) ALEATOIRES : FASCICULE 42 FIGURE 17
ROTATION DU POUSSOIR AUTOUR DE L'AXE Z:

CARACTERISTIQUES MECANIKUES DE LA VALIDATION

FORCES : SUIVANT Z
FORCE DE COMMANDE :
FORCE DE RELACHEMENT :
FORCE ADMISSIBLE EN FIN DE COURSE:
FORCE ADMISSIBLE A LA TRACTION :
COURSE TOTALE :
COURSE D'APPROCHE A LA COMMUTATION :

ELECTRICAL CHARACTERISTICS OF 2 CIRCUITS

ELECTRICAL ENDURANCE : 100 000 CYCLES

Voltage	30 Vdc	115 Vac 400 Hz	MINIMUM
Résistor	2A	2A	5 Vdc
sel.induc.L/R=5ms	1A	1A	
Minimum current	0.5mA	0.5mA	*

* CONTACT RESISTANCE IN ACCORDANCE WITH MIL 8805 D

CARACTERISTIQUES GENERALES

TEMPERATURE D'EMPLOI:
TEMPERATURE DE STOCKAGE:
MASSE:

USINAGE PLATINE
PLATE MACHINING

**FIXATION PAR COLLAGE
ASSEMBLING BY GLUE**

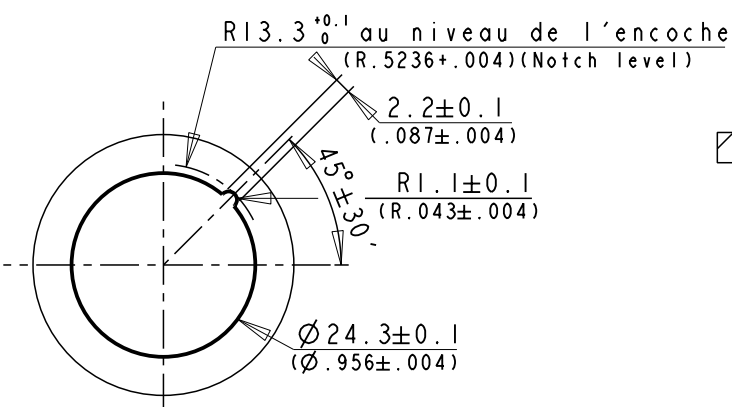

PRESENTATION

WATERPROOF FRONT FACE - MIL STD 810D-506.2 METH.2
CASING AND BUTTON POLYAMIDE 6-6 BLACK
SOLDER TERMINAL LUGS SILVER-PLATED BRASS
CONTACTS: SILVER

MECHANICALS PROPERTIES OF 2 DIRECTIONS

F (SEE FIG.)

OPERATING FORCE: 4.5N±1.5N.
REALEASE FORCE: 0.6N MIN.
PERMISSIBLE FORCE AT END OF TRAVEL: 70N MAX.
PLUNGER STRENGTHNESS: PULLING ACTION: 25N MAX.
PUSHING ACTION: 100N MAX.

ANGLE MEASURED FROM THE AXIS:
PRE TRAVEL (CA): 9°30' MAX.
OVERTRAVEL (CRA): 1°30' MIN.
RETURN OVERTRAVEL (CRR): 4° MIN.
MECHANICAL STRENGTH PER DIRECTION:
VIBRATIONS: IN ACCORDANCE WITH AIR 7306 TITRE 3
a) SINUSOIDAL=PART 41-TABLE 2
b) RANDOM=PART 42-SCHEME 17
ROTATION PUCH AROUND THE Z AXIS: 5° MAX

VALIDATION MECHANICALS PROPERTIES

Z SEE FIG.
OPERATING FORCE : 25N MAX
REALEASE FORCE: 2N MINI.
MAX. AUTHORIZED FORCE AT END OF TRAVEL: 70N MAX.
PLUNGER STRENGTHNESS:PULLING ACTION: 80N MAX.
TOTAL TRAVEL: 2mm MINI.(.078 IN.)
1.8mm MAX.(.07 IN.)
SWITCHING PRE TRAVEL:

ELECTRICAL CHARACTERISTICS OF VALIDATION CIRCUIT

ELECTRICAL ENDURANCE : 50 000 CYCLES

Voltage	30 Vdc	115 Vac 400 Hz	MINIMUM
Résistor	0.5A	0.5A	5 Vdc
Minimum current	0.5mA	0.5mA	*

GENERAL PROPERTIE

OPERATING TEMPERATURE: -55°C A +85°C
STORAGE TEMPERATURE: -55°C A +85°C
MASSE: 0.00735Kg ±5%

**SCHEMA DES COURSES
TRAVEL SCHEME**

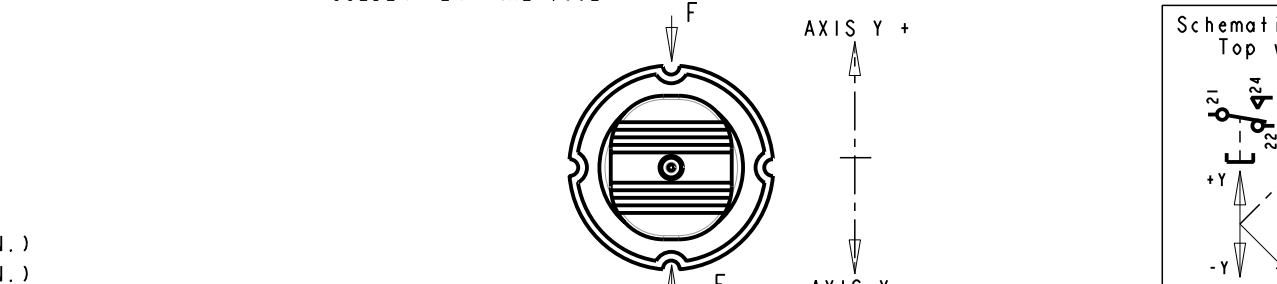
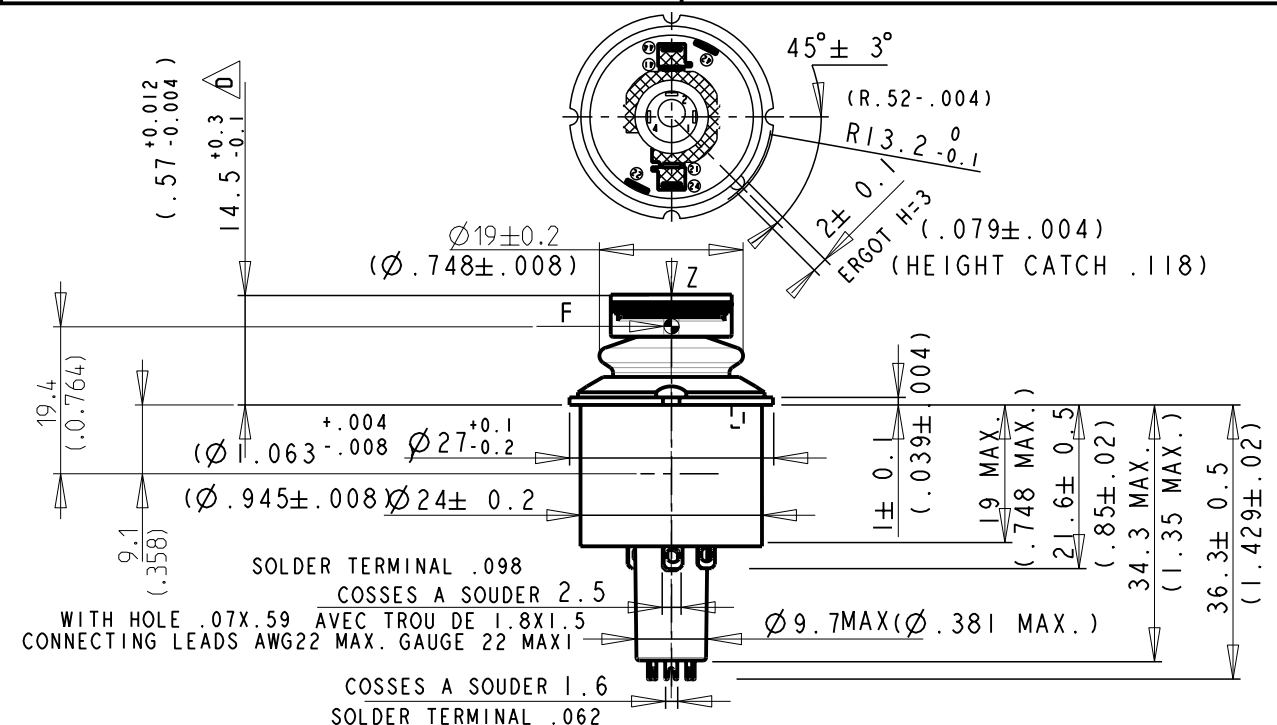
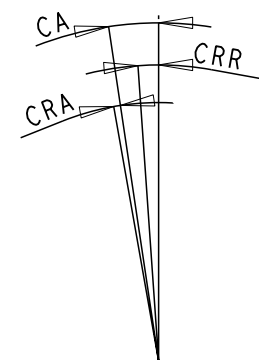

USINAGE PLATINE
PLATE MACHINING

**FIXATION PAR VIS
SCREW MOUNTING**

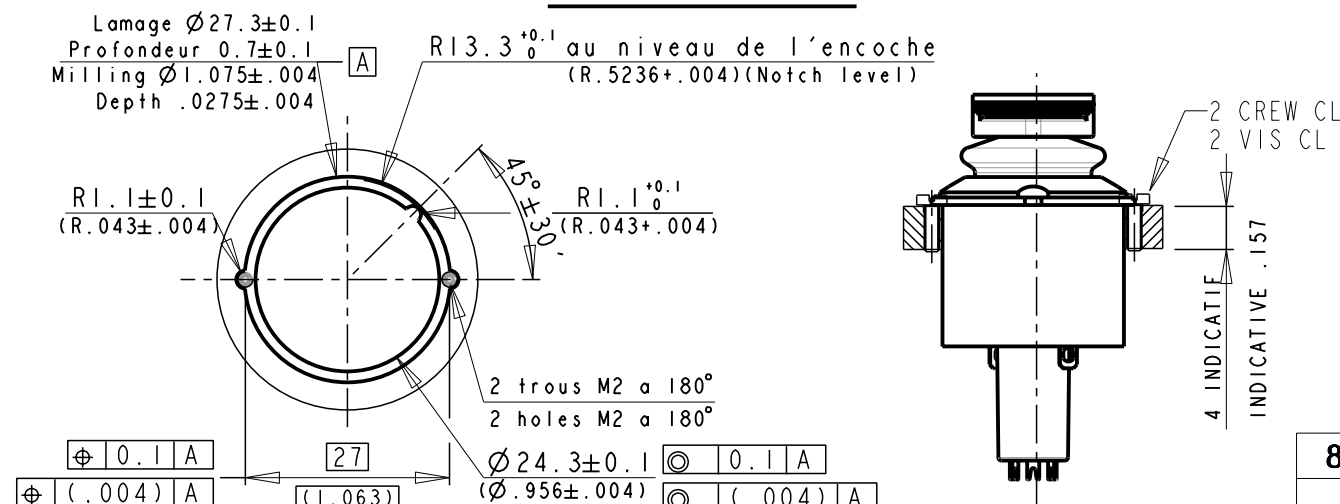

83452722
Product:

D	Modification HSS-DDM-23/07-01896 changing tolerances Zone A3 dimension 14.5 ±0.6 becomes 14.5 (-0.1/+0.3)	Modified by	J_BENKERT	18/09/2023
		Verified by	K_CREST	18/09/2023
		Authorized by	D_ASTIER	18/09/2023

Toler. gene. lin ±	0.1	mm	This document is the property of Crouzet-Automatismes. It's contents cannot be reproduced or divulged without the company's written approval. The product data and specifications found on this document do not constitute any contractual obligation. Crouzet-Automatismes and its subsidiaries reserve the right to modify the specifications. All rights of reproduction, modification, reprinting, and translation reserved for all countries.	Scale 1/1
Toler. gene. Ang ±	1	degrees		

CROUZET 12, rue Jean-Jullien DAVIN CS 60059 26902 Valence CEDEX 9 France	Customer:	Customer Ref.:	PFT001:0<C>;0<M>	
	Designation/FR:	TRIM 2D CONCAVE ETANCHE A VALIDATION INVERSEUR		
	Designation/GB:	WATERPROOF 2 WAY BUTTON + PUSH BUTTON REVERSING SWITCH		
Request:	Designed by	L_BERGERON 21/02/2013	Department	CT
HSS-DDM-23/07-01896	Verified by	D_ASTIER 21/02/2013	Index	D
NATO code: FAOX2	Authorized by	NON APPLIC.	Format	A3
DATA SHEET			Folio	1/1
FT83452722FR				