

Couple de serrage/Tightening torque :

Ecrou canon/Threaded Barrel : 5,0 N.m max
Recommande/Recommended : 4,0 +-0,25 N.m

Vis de connection/terminal screw : 2,0 N.m max
Recommande/Recommended : 1,6 +-0,1 N.m

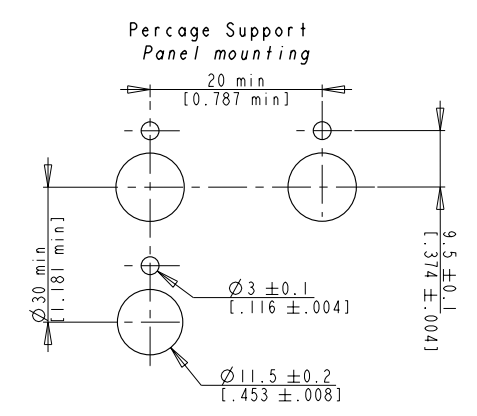

B	Updating data sheet acc. to MS26574		Modified by	F_VILLE	04/10/2017
			Verified by	D_MEUX	04/10/2017
		Authorized by			
Toler. gene. lin ± 0.2 mm		This document is the property of Crouzet-Automatismes. It's contents cannot be reproduced or divulged without the company's written approval. The product data and specifications found on this document do not constitute any contractual obligation. Crouzet-Automatismes and its subsidiaries reserve the right to modify the specifications. All rights of reproduction, modification, reprinting, and translation reserved for all countries.			
Toler. gene. Ang ± 3 degrees					
CROUZET	General Raw surface Ra ✓	Scale 3/2			
2. rue du Dr ABEL BP 59. 26902. Valence CEDEX 9 France		Customer:		Customer Ref.:	
Request:		Designation/FR: DISJONCTEUR THERMIQUE UNIPOLAIRE POUSSE TIRE MS26574		PFT001:<C>;<M>	
-		Designation/GB: SINGLE POLE THERMAL CIRCUIT BREAKER PUSH PULL MS26574		Department CT	
NATO code: FA0X2		Request:		Index	
		Design by F_VILLE 02/06/2015		Format	
		Verif. by D_MEUX 02/06/2015		Folio	
		Authorized by		B A3 1/2	
		FT844060_001FR			

Caracteristiques suivant / Features according to : AS26574 and MS26574

- Masse / Weight: 20g max
- Tension d'utilisation / Operating voltage: 28VDC - 115VAC 360-900Hz
- Temperature d'utilisation / Operational temperature limits: - 55 °C - +71 °C
- Endurance electromecanique / Electromechanical endurance: 5000cycles a vide + 2500 cycles en charge (resistif-inductif cosfi 0.7)
5000cycles without a load+2500cycles loaded (resistive-inductive power factor 0.7)
- Vibration sinus / Sinusoidale vibration: 10 g-PK condition C suivant MIL STD-202 methode 204D
10 g-PK condition C according to MIL STD-202 method 204D
- Vibration aléatoire / Random vibration: 9.26 Grms condition C suivant MIL STD-202 methode 214A
9.26 Grms condition C according to MIL STD-202 method 214A
- Choc mecanique / Mechanical shock: 50 g 11msec 3 demi-sinusoidale 6 directions
50 g 11msec 3 half-sine 6 directions
- Corrosion / Corrosion: 48 heures brouillard salin
Salt spray 48 hours
- Pouvoir de coupure / Breaking capacity: 2000A RMS @ 115V-400Hz AC *voir note 1
6000A @ 28VDC *see note 1
- Chute de tension / Voltage drop

- Seuils et temps de declenchement :
Thresholds and tripping time

Calibre rating	Temperature	Seuils declenchement non declenchement %In Trip and no trip thresholds %In		Temps de declenchement en seconde Tripping times in seconde		
		Declenchement Trip	Non declenchement Non trip	200 %In	500 %In	1000 %In
1A => 30A	- 55°C	180	115	35 max	2 max	0.4 max
1A => 30A	23 °C	150	115	4 to 20	0.2 to 1.2	0.046 to 0.8
1A => 30A	71 °C	140	90	1.5 min	0.2 min	0.04 min

Calibre Rating	Volts
1/2A	2.2 max
1A	1.10V max
2A	0.5V max
2 1/2A	0.6V max
3A	0.35V max
5A	0.25V max
7 1/2A	0.20V max
10A	0.20V max
15A	0.15V max
20A	0.15V max
25A	0.15V max
30A	0.25V max



-Tripping curve

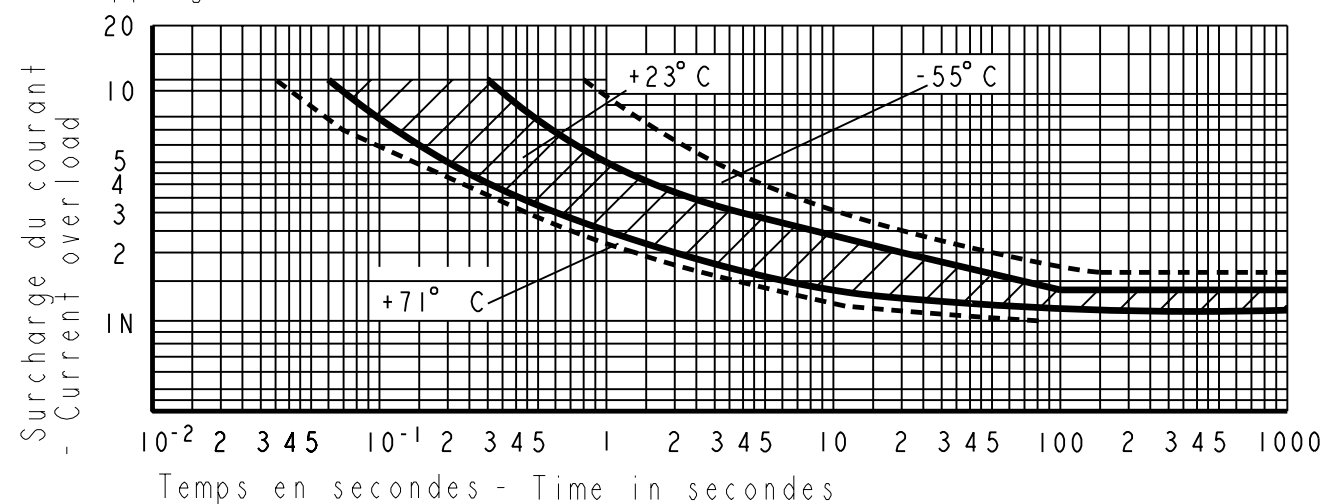

Documents associes / Associated documents	
Plan de marquage / Marking drawing	MA844000001FR
Plan d'ensemble / Assembly drawing	EN844060_001FR

- Reference Produit / Product reference

Calibre Rating	Reference produit / Product reference
0.5A	84-406-011
1A	84-406-001
2A	84-406-002
2.5A	84-406-012
3A	84-406-003
5A	84-406-005
7.5A	84-406-007
10A	84-406-010
15A	84-406-015
20A	84-406-020
25A	84-406-025
30A	84-406-030

Marquage produit / Marking product :

Reference -----> 84406003-3A
Norme / Standard -----> MS26574-3
MS26574-C3

Date -----> YY-WW
YY : Annee / Year (2 digits)
WW : Semaine / Week (2 digits)

* Note 1 : Pour le calibre 30A, lors du test a 2000A et 6000A, l'ouverture permanente du disjoncteur (sans eclatement, de flammes ou fumees epaisses) est autorisee.
For rating 30A, during the test at 2000A and 6000A, the permanent opening of the circuit breaker (without bursting, flames or thick smokes) is allowed

B	Updating data sheet acc. to MS26574		Modified by	F_VILLE	04/10/2017
			Verified by	D_MEUX	04/10/2017
		Authorized by			
Toler. gene. lin ± 0.2 mm		<p>This document is the property of Crouzet-Automatismes. It's contents cannot be reproduced or divulged without the company's written approval. The product data and specifications found on this document do not constitute any contractual obligation. Crouzet-Automatismes and its subsidiaries reserve the right to modify the specifications. All rights of reproduction, modification, reprinting, and translation reserved for all countries.</p>			
Toler. gene. Ang ± 3 degrees					
CROUZET	General Raw surface Ra ✓	Scale 1/1			
2, rue du Dr ABEL BP 59, 26902, Valence CEDEX 9 France		Customer:		Customer Ref.:	
		Designation/FR: DISJONCTEUR THERMIQUE UNIPOLAIRE POUSSE TIRE MS26574		PFT001;<C>;<M>	
		Designation/GB: SINGLE POLE THERMAL CIRCUIT BREAKER PUSH PULL MS26574		Department CT	
Request:		Designed by F_VILLE 02/06/2015		DATA SHEET	
		Verified by D_MEUX 02/06/2015		Index Format Folio	
NATO code: FA0X2		Authorized by		FT844060_001FR	
				B A3 2/2	