



Model MI57DA

For Indicators qualified to MIL-PRF-83287/2, see page 28.

The MI57DA magnetic latching fault indicator displays a highly visible dual color internal flag when the indicator coil is pulsed by a BITE (Built-in Test Equipment) system. The “cloverleaf” pattern provides a high-contrast, visual identification and an effective warning of system results.

FEATURES

- Electrical reset
- Magnetically latching
- Positive identification
- Environmentally sealed
- Rear mount

OPERATION

When the indicator coil is energized with a 40 millisecond (or longer) pulse, the highly visible display disc rotates and latches to the magnetic core. The display disc will remain magnetically latched to the core in the position last pulsed. Even if the fault signal is removed, the indicator will “remember” that a fault had occurred. Return to the “No-fault” position is accomplished electromechanically by pulsing a separate coil.

ELECTRICAL SPECIFICATIONS

| Standard coil voltages and resistances | | | |
|--|---------------------------|---------------------------|-----------------------------------|
| Nominal Voltage DC | Operating Voltage Minimum | Operating Voltage Maximum | DC Coil Resistance in Ohms, @25°C |
| 5.0 | 4.0 | 6.0 | 19-35 |
| 12.0 | 9.6 | 14.4 | 130-230 |
| 28.0 | 22.4 | 30.0 | 675-880 |

Pulse Power: One Watt. Nominal

Nominal Pulse Length: 40 milliseconds, minimum with a maximum rise time of 5 milliseconds

Dielectric Withstanding Voltage: 500 VAC RMS

Insulation Resistance: 100 megohms minimum at 500 VDC



MI57DA

MECHANICAL SPECIFICATIONS

Case: Black, anodized aluminum.

Mounting: Rear mount (D-hole or keyed washer).

Display Colors: “No-fault” is black, “Fault” is black/white

Leads: WL-Eight inches of #26 AWG Teflon insulated wire leads, turret terminals (TT), and loop terminals (LT).

Glass: Standard (S), Non-glare (N)

ENVIRONMENTAL SPECIFICATIONS

Operating Temperature Range: -65°C to +125°C

Vibration*:

Sinusoidal: .06" D.A. or 20 Gs Peak, whichever is less, 10Hz to 2kHz per MIL STD 202, Method 204, Test Condition D

Random: 11.6 Gs per MIL STD 202, Method 214, Test Condition D, Curve 1

Shock: 100 Gs MIL STD 202, Method 213, Test Condition I

Moisture Resistance: (Humidity): MIL STD 202, Method 106

Thermal Shock: MIL STD 202, Method 107, Test Condition B

Salt Spray: MIL STD 202, Method 101, Test Condition B

Barometric Pressure: 100,000 ft. MIL STD 202, Method 105, Test Condition D, 350 VAC RMS

Life: 100,000 cycles

* (During vibration testing caution should be taken to shield the indicator from the strong magnetic field.)

Optional: RFI panel shielding available

This page consists of basic marketing information that is not defined as technical data under EAR Part 772.

BITE INDICATORS



ORDERING INFORMATION

When ordering, show model number first, coil voltage, the color combination desired, terminal type, and glass type. If this is a special part, a factory assigned modification number will be added at the end of the ordering number. Consult the factory for special configurations.

Example:

Basic model with front panel threaded case for 12 volts with black/white as set color and all black as reset color, wire leads, non-glare glass would be Model MI57DA-12-W/BLK-WL-N.

MI57DA - 12 - W / BLK - WL - S - ()

Standard factory options are designated by "-Sxxx"

| Basic Model Number | Coil Voltage | Fault or Set Color | No-fault or Reset Color | Terminal Type | Glass Type |
|--------------------|--------------|--------------------|-------------------------|---------------------|-------------------|
| MI57DA | 5 | Black/White | Black | LT Loop Terminals | S Standard Glass |
| | 12 | | | TT Turret Terminals | N Non-glare Glass |
| | 28 | | | WL Wire Leads | |

Loop Terminal Option

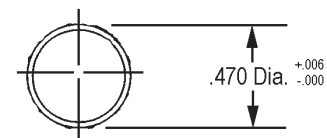
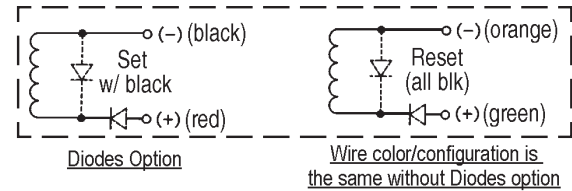
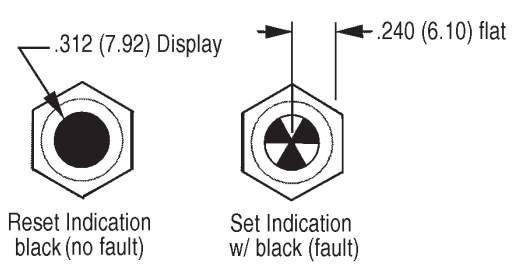
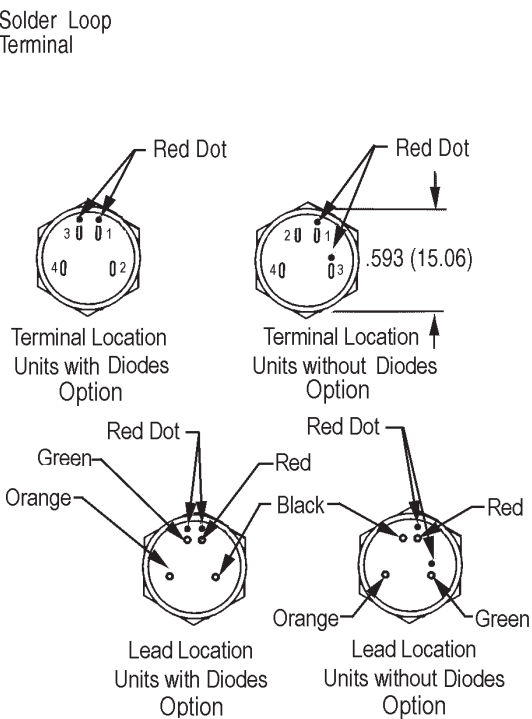
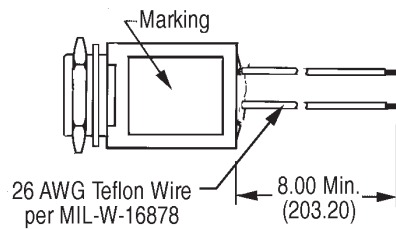
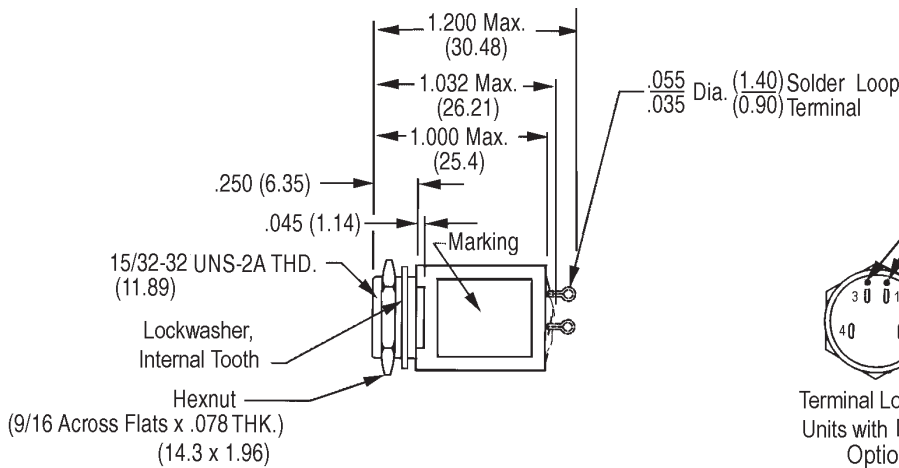

Panel Layout

MI57DA

NOTE: Dimensions in () are mm. Tolerances: Decimals: ± .010 (0.25)
Fractions: ± 1/64—All mounting hardware is black anodized aluminum. Mounting Torque: 5-7 in. lbs.

This page consists of basic marketing information that is not defined as technical data under EAR Part 772.

FLAG INDICATORS