

## ELECTRICAL & POWER

# NEW SM15 CONTACTORS TO MEET THE PERFORMANCE NEEDS OF THE MS27751

Safran Electrical & Power's facility in Sarasota is a leading manufacturer of Aerospace contactors. For decades Safran Electrical & Power has been producing the SM15 family of contactors. Many contactors in this family meet the demanding performance requirements of MIL-PRF-6106 and are sole source on the qualified product database for many of the military specification "slash" sheets of this base specification. One "slash" sheet, the MS27751 family, can be satisfied fit and functionally by some of these NEW SM15 contactors.

## THE NEW LINE OF SM15 CONTACTORS

PART NUMBER	MS27751 Functional / Fit Equivalent	Coil Data			
		Volts	Freq	Inrush	Steady State
SM15AWA1	MS27751-4	115VAC	400Hz	0.71A	0.1A
SM15CWD8	MS27751-1	28VDC	DC	1.25A	0.25A
SM15CXD24*	MS27751-7, MS27751-19	28VDC	DC	1.25A	0.25A
SM15CXA11	MS27751-18	115VAC	400Hz	0.71A	0.1A
SM15CWD9	MS27751-21	28VDC	DC	1.25A	0.25A

\*The SM15CXD24 has both a set of NO (Normally Open) auxiliary contacts and a set of NC (Normally Closed) auxiliary contacts. It can be wired to utilize either set or both depending on application



### KEY FEATURES & BENEFITS

- Compact low profile design
- Mature/proven family of contactors
- Improved performance over the competition

### APPLICATIONS

- 3 Phase 115VAC 400Hz Power Distribution
- Electrical Loads up to 60A
- Altitudes up to 50,000 ft
- Temperature Range -55C to 71C

## KEY PARAMETER COMPARISON

OPERATING CHARACTERISTICS	SM 15 FAMILY	MS27751
Operate Time	25ms	50ms
Release Time	25ms	25ms
Main Contact Bounce	2ms	3ms
Dielectric Strength	1250 Vrms	1000 Vrms
Insulation Resistance	200 MΩ	100 MΩ

RATED CONTACT LOAD	SM 15 FAMILY	MS27751
Resistive (Cycles / Current)	100,000 / 60A	50,000 / 60A
Inductive (Cycles / Current)	100,000 / 60A	50,000 / 60A
Motor (Cycles / Current)	50,000 / 40A	50,000 / 40A
Mechanical Life (Cycles / Current)	200,000 / 15A	200,000 / 14A

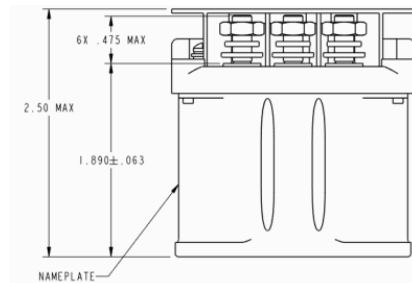
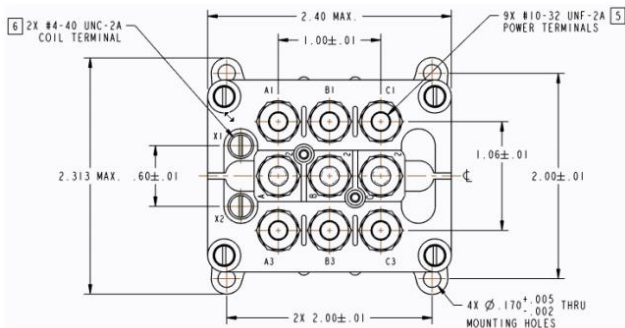

SM15WA1 height  
\*other dimensions same as below

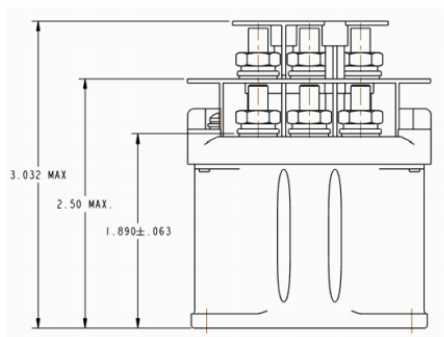

SM15CWD8, SM15CXD24, SM15CXA11, SM15CWD9 DIMENSIONS

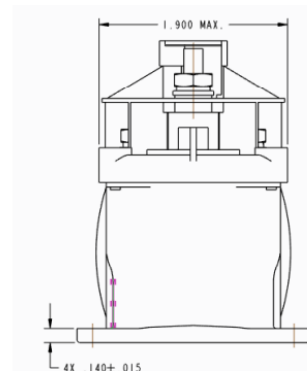

### SAFRAN ELECTRICAL & POWER

2250 Whitfield Avenue  
Sarasota, FL 34243 USA  
Tel. 1-800-955-7354 Fax 941-751-7173  
TechnicalSupport.SRQ@SafranGroup.com

**POWERED  
BY TRUST**

